

DOOR CONTROL SWITCH (for Driver Side)

COMPONENTS

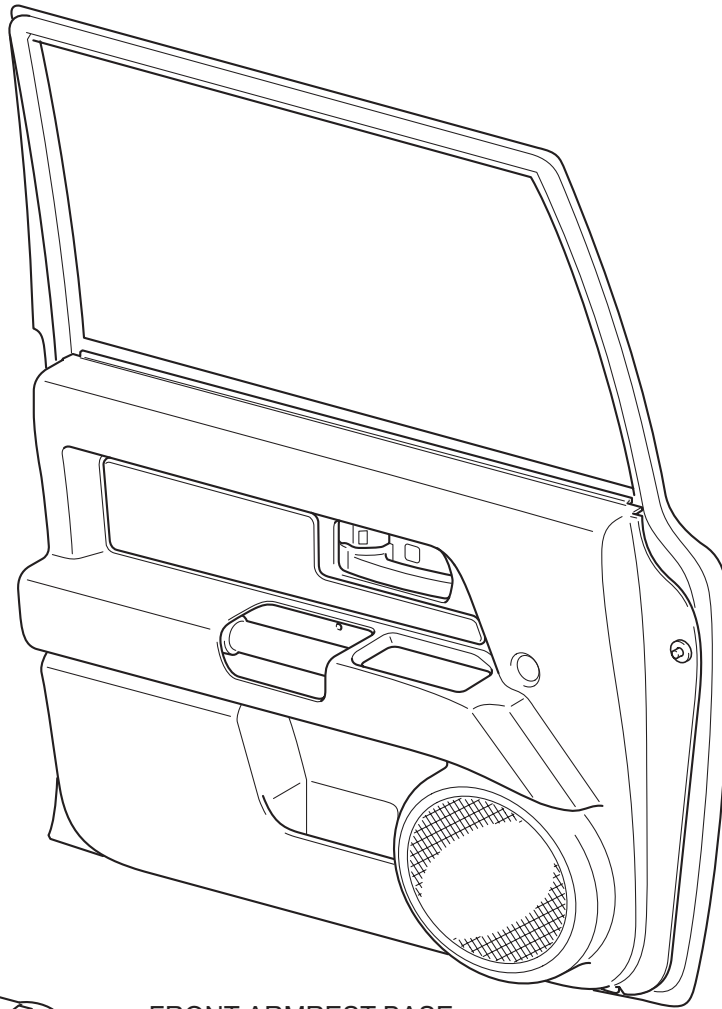

FRONT ARMREST BASE
UPPER PANEL

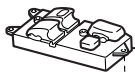

POWER WINDOW REGULATOR
MASTER SWITCH ASSEMBLY

x3 

DL

REMOVAL

1. **DISCONNECT CABLE FROM NEGATIVE BATTERY TERMINAL**
2. **REMOVE FRONT ARMREST BASE UPPER PANEL**
(See page [WS-25](#))
3. **REMOVE POWER WINDOW REGULATOR MASTER SWITCH ASSEMBLY**
 - (a) Remove the 3 screws and the power window regulator master switch.

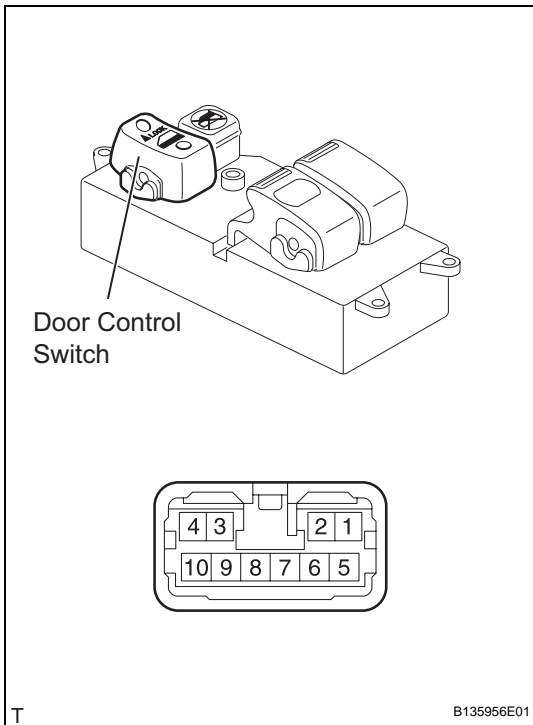
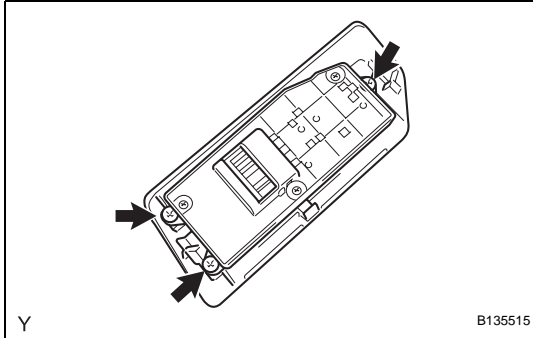

INSPECTION

1. **INSPECT POWER WINDOW REGULATOR MASTER SWITCH ASSEMBLY**
 - (a) Check the resistance of the door control switch.
 - (1) Using an ohmmeter, measure the resistance and check the results in accordance with the value(s) in the table below.

Standard Resistance

Tester Connection	Switch Condition	Specified Condition
1 - 2	Locked	Below 1 Ω
1 - 2	OFF	10 k Ω or higher
1 - 5	OFF	10 k Ω or higher
1 - 5	Unlocked	Below 1 Ω

If the result is not as specified, replace the power window regulator master switch.

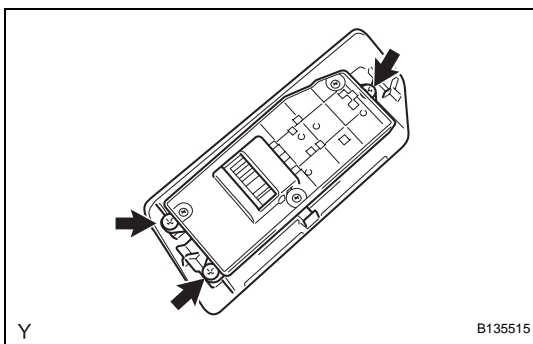

INSTALLATION

1. **INSTALL POWER WINDOW REGULATOR MASTER SWITCH ASSEMBLY**
 - (a) Install the power window regulator master switch with the 3 screws.
2. **INSTALL FRONT ARMREST BASE UPPER PANEL**
(See page [WS-27](#))
3. **CONNECT CABLE TO NEGATIVE BATTERY TERMINAL**
Torque: 3.9 N*m (40 kgf*cm, 35 in.*lbf)